

**5GHz 802.11ac 900Mbps TDMA Outdoor  
Long Range Wireless CPE**

**WBS-900AC**





Quick Installation Guide

# Table of Contents

1. Package Contents .....	3
2. Physical Introduction .....	4
3. Hardware Installation .....	5
4. Wired Network Configuration (Windows) .....	7
5. Entering into the Web Management.....	8
6. Further Information .....	9

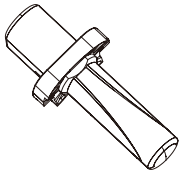
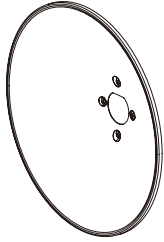
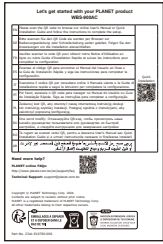
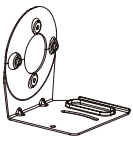
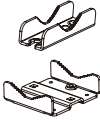
# 1. Package Contents

Thank you for choosing PLANET TDMA Outdoor Long Range Wireless CPE. Before installing, please verify the contents inside the package box. The "WBS-900AC" mentioned here is the model name of the device.

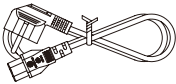
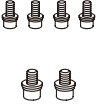
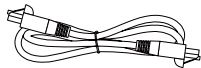
WBS-900AC x1	Parabolic Reflector x 1		QR Code Sheet
			
L Clip x 1	Clip x 2	Hex Nut x 2	Nut x 2
			
PoE Power Adapter x 1	Power Cable x 1	Screw x 6	RJ45 Cable
			



Note

If there is any item missing or damaged, please contact the seller immediately.

## 2. Physical Introduction

### Hardware Description

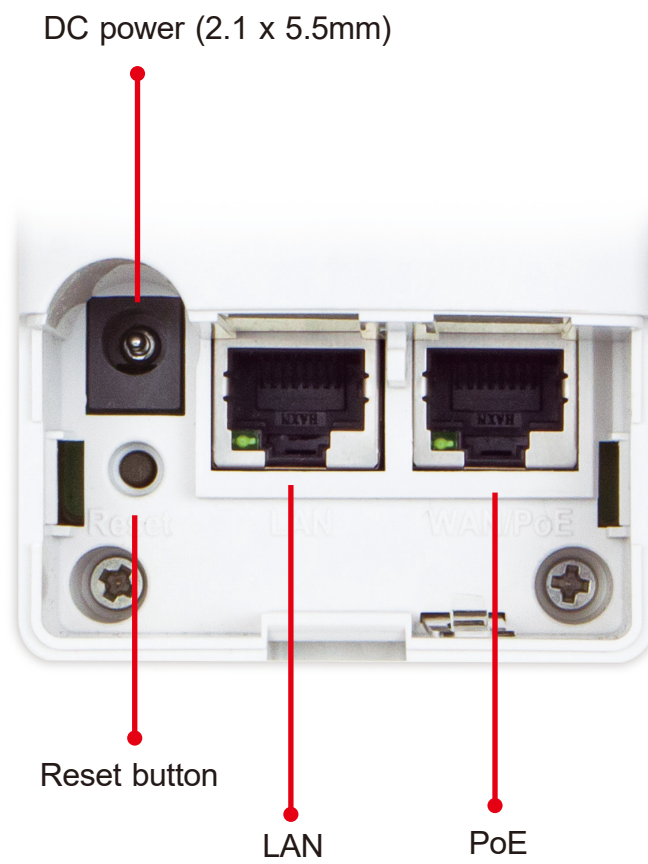

### 3. Hardware Installation

#### Step 1: Installing Antenna Set and AP Stand

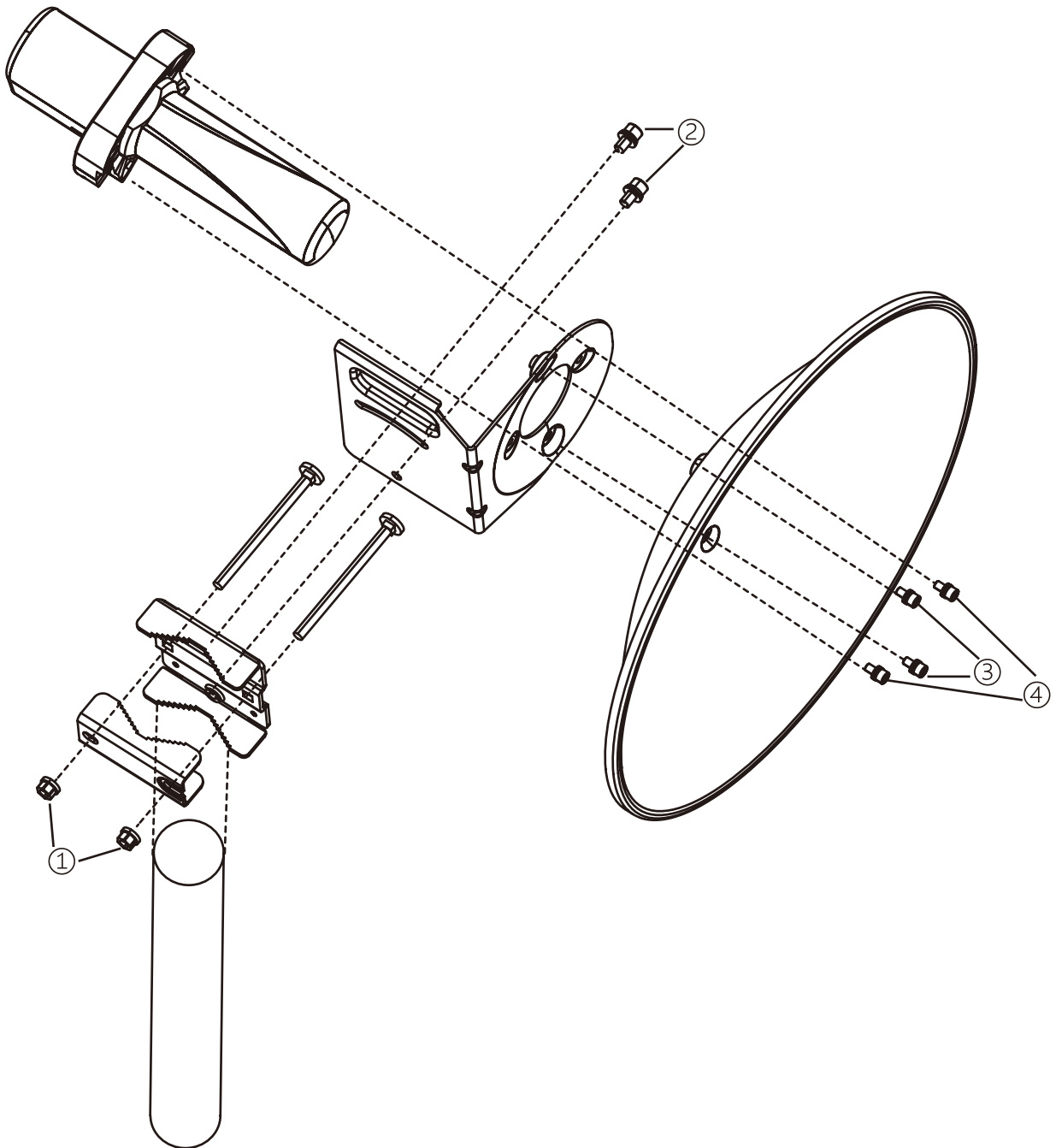

Note

Proper installation requires positioning the exhaust vent facing downwards.

**Step 2:** Push the latch on the bottom of the Outdoor Wireless CPE to remove the sliding cover.

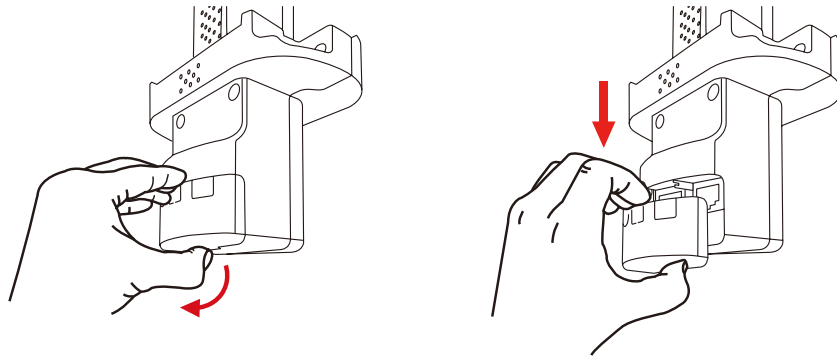

**Step 3:** Plug the RJ45 Ethernet cable into the PoE Port of the Outdoor Wireless CPE. Then, slide back the cover to finish the installation.

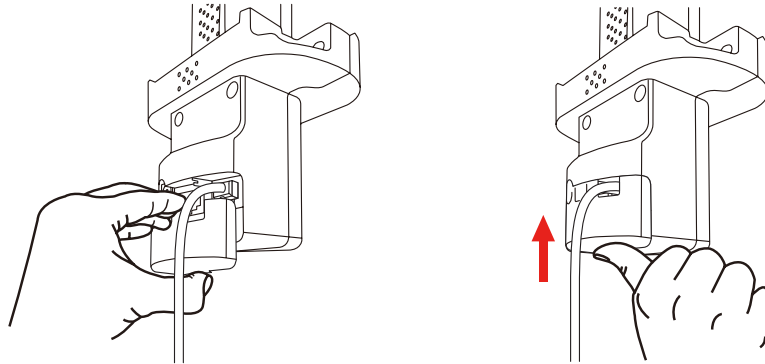

## 4. Wired Network Configuration (Windows)

A computer with wired Ethernet connection is required for the first-time configuration of the Wireless AP.

1. Click the **"Start"** button located at the lower-left corner of your computer.
2. Select **"Control Panel-> Network and Sharing Center"**.
3. Click **"Change adapter settings"**.
4. Double-click **"Local Area Connection"**.
5. Select **"Internet Protocol Version 4 (TCP/IPv4)"** and click **"Properties"**.
6. Select **"Use the following IP address"** to configure the IP address to **"192.168.1.x"** ("x" can be any number from 2 to 254, except 253) and then click the **"OK"** button to save the configuration.

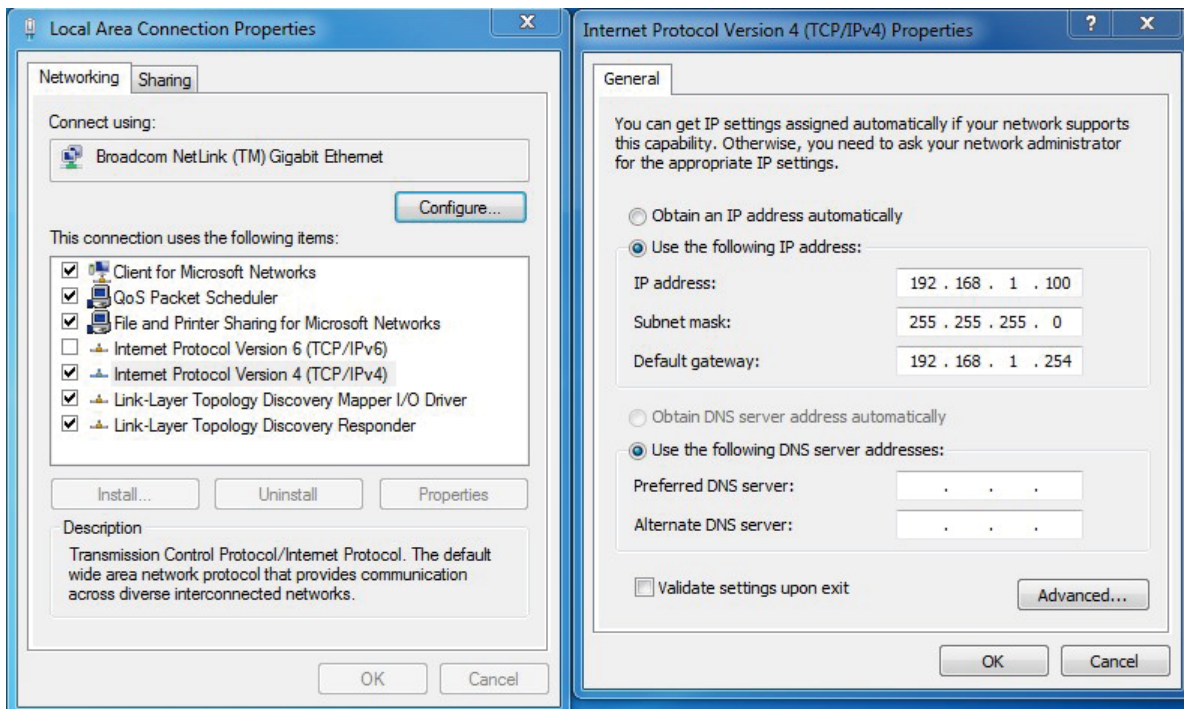

## 5. Entering into the Web Management

Default IP Address: **192.168.1.253**

Default Username: **admin**

Default Password: **ap + the last 6 characters of the MAC ID in lowercase**

Default SSID: **PLANET\_5G**

Step 1: Launch the Web browser and enter the default Master IP address **https://192.168.1.253**.

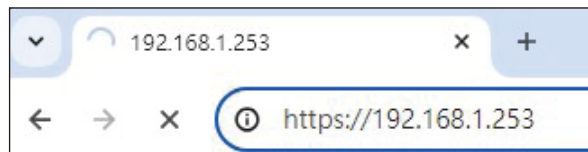

Step 2: The default username is "admin" and the password is "ap" followed by the last 6 characters of the MAC ID in lowercase. Then click the LOGIN button to continue.

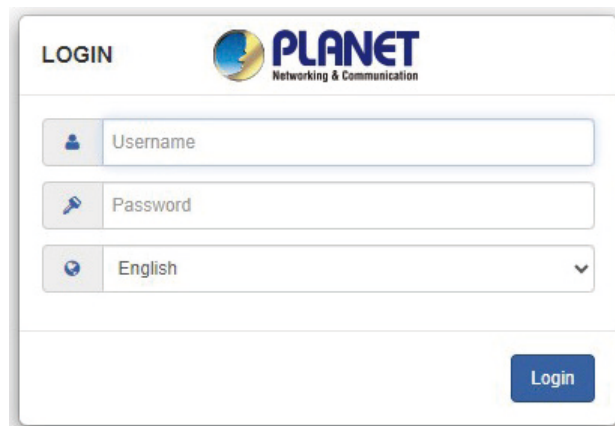
A screenshot of the PLANET login page. The page has a header with the word 'LOGIN' and the PLANET logo (a globe icon) with the text 'PLANET Networking & Communication'. Below the header are three input fields: 'Username' with a person icon, 'Password' with a key icon, and 'English' with a dropdown arrow. At the bottom right of the form is a blue 'Login' button.

For security reasons, it is recommended to change the password at the first login and memorize it.



## 6. Further Information

The above steps introduce the simple installations and configurations of the device. For further configurations, please refer to the user manual, which can be downloaded from the website.

WBS-900AC

<https://www.planet.com.tw/en/support/downloads?&method=keyword&keyword=WBS-900&view=3#list>



Copyright © PLANET Technology Corp. 2024.

Contents are subject to revision without prior notice.

PLANET is a registered trademark of PLANET Technology Corp.

All other trademarks belong to their respective owners.