

**Industrial 8-port 10/100/1000T Wall-mounted Gigabit
Ethernet Switch with 4-port PoE+**

**WGS-804HP
User's Manual**

Table of Contents

1. Package Contents.....	3
2. Hardware Description.....	4
2.1 Terminal Block Connector Pinouts.....	4
2.2 LED Indicators.....	5
2.3 Product Specifications	7
2.4 Physical Dimensions.....	10
3. Installation	11
3.1 Wall-mount Installation	11
3.2 DIN-rail Mounting Installation	12
3.3 Magnet Installation	13
4. Customer Support.....	14

1. Package Contents

Thank you for purchasing PLANET WGS-804HP Industrial 8-port 10/100/1000T Wall-mounted Gigabit Ethernet Switch with 4-port PoE+. **“Wall-mounted PoE+ Switch”** mentioned in this Guide refers to the WGS-804HP.

Open the box of the Wall-mounted PoE+ Switch and carefully unpack it. The box should contain the following items

<p>The Wall-mounted PoE+ Switch x 1</p>	<p>QR Code Sheet x 1 pc</p>		<p>Wall-mounted Kit x 1 set</p>
			
<p>DIN-rail Kit x 1 set</p>	<p>Magnet Kit x 1 set</p>	<p>3-pin Terminal Block Connector x 1 pc</p>	<p>RJ45 Dust Cap x 8</p>
			

If any item is found missing or damaged, please contact your local reseller for replacement.

2. Hardware Description

The front panel of the WGS-804HP Wall-mounted PoE+ Switch consists of 8 auto-sensing 10/100/1000Mbps Ethernet RJ45 ports. The LED indicators are also located on the RJ45 ports of the Wall-mounted PoE+ Switch.

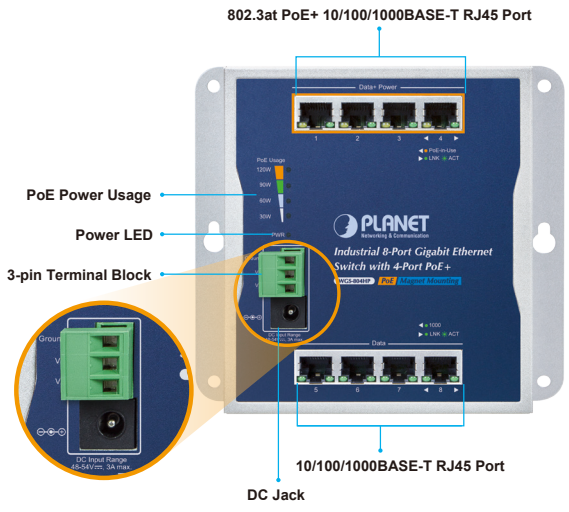

2.1 Terminal Block Connector Pinouts

To install the 3-pin Terminal Block Connector on the WGS-804HP, simply follow the following steps:

Step 1: Insert positive DC power wire into V+, negative DC power wire into V-, and ground wire into Ground.

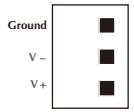

Step 2: Tighten the wire-clamp screws for preventing the wires from loosening and plug into the Wall-mounted PoE+ Switch.



Note

1. The wire gauge should be in the range from 12 to 24 AWG.
2. The device must be grounded.
3. The DC power input range is 48V ~ 54V DC.

2.2 LED Indicators

■ System

LED	Color	Function
PWR	Green	Lights to indicate that the Switch has power.

■ PoE 10/100/1000BASE-T Interfaces (Ports 1 to 4)

LED	Color	Function	
LNK/ACT	Green	Lights	To indicate the link through that port is successfully established.
		Blinks	To indicate that the switch is actively sending or receiving data over that port.
		Off	If LNK/ACT LED is off, it indicates that the port is link-down.
PoE-in-Use	Amber	Lights	To indicate the port is providing DC in-line power.
		Off	To indicate the connected device is not a PoE powered device (PD).

■ 10/100/1000BASE-T Interfaces (Ports 5 to 8)

LED	Color	Function	
LNK/ACT	Green	Lights	To indicate the link through that port is successfully established.
		Blinks	To indicate that the switch is actively sending or receiving data over that port.
		Off	If LNK/ACT LED is off, it indicates that the port is link-down.
1000	Green	Lights	To indicate that the port is operating at 1000Mbps .
		Off	If 1000 LED is off, it indicates that the port is operating at 10/100Mbps .

■ PoE Power Usage (Unit: Watt)

LED	Color	Function	
30	Amber	Lights	To indicate the system consumes over 30-watt PoE power budget.
60	Amber	Lights	To indicate the system consumes over 60-watt PoE power budget.
90	Amber	Lights	To indicate the system consumes over 90-watt PoE power budget.
120	Amber	Lights	To indicate the system consumes over 120-watt PoE power budget.

2.3 Product Specifications

Product	WGS-804HP
Hardware Specifications	
Copper Ports	8 10/100/1000BASE-T RJ45 auto-MDI/MDI-X ports
PoE Inject Port	4-Port with 802.3af/802.3at PoE injector function (Ports 1 to 4)
Connector	<ul style="list-style-type: none"> ■ Removable 3-pin terminal block for power input <ul style="list-style-type: none"> - Pin 1/2 for Power (Pin 1: V+ / Pin 2: V-) - Pin 3 for earth ground ■ DC power jack with 2.0mm central pole
Power Requirements	48V~54V DC, 3A (max.)
Power Consumption/ Dissipation	Max.130 watts/443 BTU
Dimensions (W x D x H)	148 x 25 x 134 mm
Weight	561g
ESD Protection	Contact Discharge 6KV DC Air Discharge 6KV DC
Enclosure	IP30 metal
Installation	Wall mount, magnetic wall mount and DIN-rail kit
LED	<p>Power LED: Power (Green)</p> <p>PoE Power Usage LED: 30W, 60W, 90W, 120W (Amber)</p> <p>PoE Ports (Ports 1 to 4): PoE-in-Use (Amber) LNK/ACT (Green)</p> <p>10/100/1000BASE-TX Ports (Ports 5 to 8): 1000 (Green) LNK/ACT (Green)</p>

Switch Specifications	
Switch Architecture	Store-and-Forward
Switch Fabric	16Gbps/non-blocking
Switch Throughput@64 bytes	11.9Mpps @64 bytes
MAC Address Table	8K entries
Shared Data Buffer	1Mbit
Flow Control	IEEE 802.3x pause frame for full duplex Back pressure for half duplex
Jumbo Frame	9KB
Power over Ethernet	
PoE Standard	IEEE 802.3af/802.3at Power over Ethernet PSE
PoE Power Supply Type	End-span
PoE Power Output	IEEE 802.3af Standard - Per port 48V~54V DC (depending on the power supply), max. 15.4 watts IEEE 802.3at Standard - Per port 50V~54V DC (depending on the power supply), max. 36 watts
Power Pin Assignment	1/2(+), 3/6(-)
PoE Power Budget	120 watts (depending on power input)
Max. Number of Class 2 PDs	4
Max. Number of Class 3 PDs	4
Max. Number of Class 4 PDs	4
Standards Conformance	
Regulatory Compliance	FCC Part 15 Class A, CE

Stability Testing	IEC 60068-2-32 (free fall) IEC 60068-2-27 (shock) IEC 60068-2-6 (vibration)
Standards Compliance	IEEE 802.3 10BASE-T IEEE 802.3u 100BASE-TX IEEE 802.3ab Gigabit 1000BASE-T IEEE 802.3x Flow Control and Back Pressure
Environment	
Operating	Temperature: -40 ~ 75 degrees C Relative Humidity: 5 ~ 95% (non-condensing)
Storage	Temperature: -40 ~ 85 degrees C Relative Humidity: 5 ~ 95% (non-condensing)
Accessories	
Standard Accessories	<ul style="list-style-type: none"> ■ QR Code Sheet x 1 ■ 3-pin Terminal Block Connector x 1 ■ Wall-mounted Kit x 1 ■ DIN-rail Kit x 1 ■ Magnet Kit x 1 ■ RJ45 Dust Cap x 8

2.4 Physical Dimensions (W x D x H): 148 x 25 x 134 mm

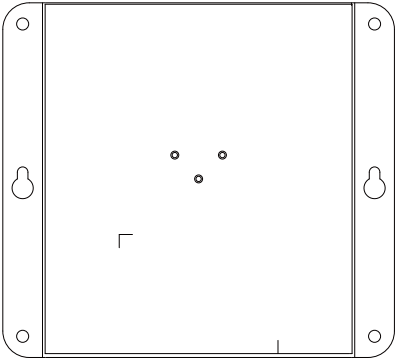
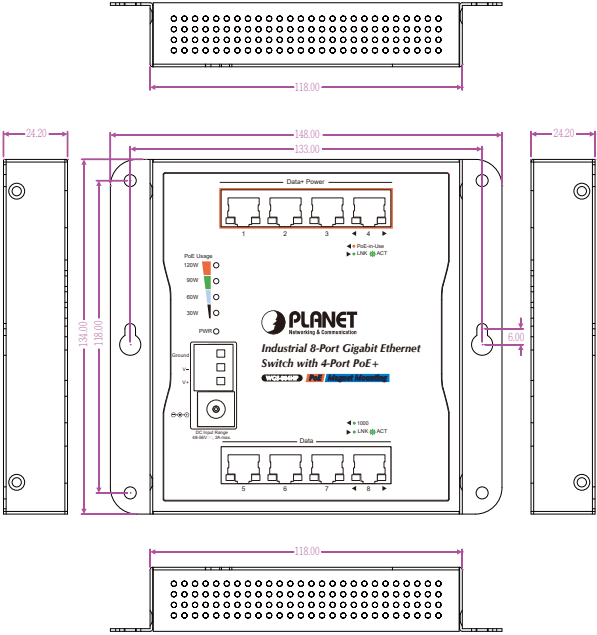

Unit: mm

3. Installation

3.1 Wall-mount Installation

To install the Wall-mounted PoE+ Switch on the wall, simply follow the following steps:

- Step 1:** There are 4 holes with 8mm diameter on the wall; the distance between the 2 holes is 133mm and the line through them must be kept horizontal.
- Step 2:** Install a conductor pipe inside the board hole and flush the edge of the conductor pipe with the wall surface.
- Step 3:** Screw the bolts into the conductor pipe. The WGS-804HP is between bolts and conductor pipe, as shown below.

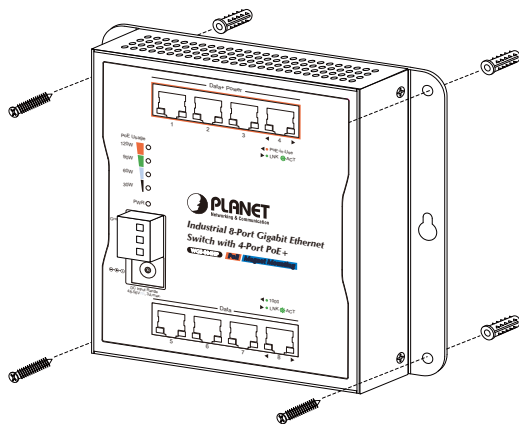

3.2 DIN-rail Mounting Installation

The DIN-rail kit is included in the WGS-804HP package. When the wall-mount application for the WGS-804HP needs to be replaced with DIN-rail application, please refer to the following figures to screw the DIN-rail on the WGS-804HP. To hang up the WGS-804HP, follow the steps below:

Step 1: Screw the DIN-rail on the WGS-804HP.

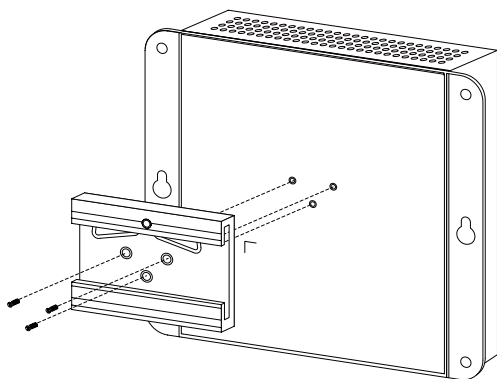

Step 2: Lightly press the bottom of DIN-rail into the track.

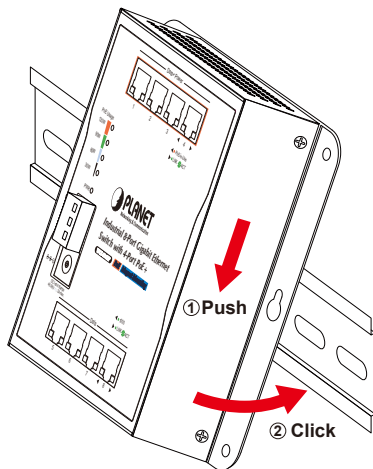

Step 3: Check whether the DIN-rail is tightly on the track.

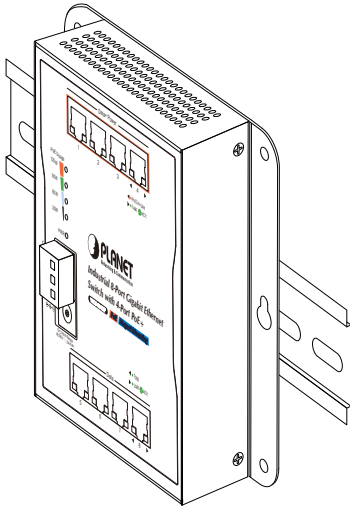

3.3 Magnet Installation

To install the WGS-804HP on a magnetic surface, simply follow the following diagram:

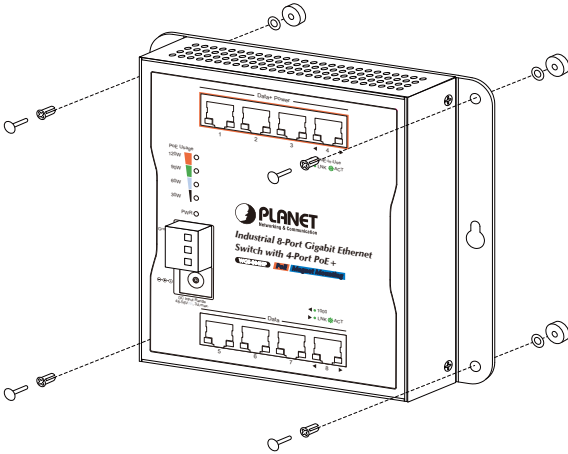

4. Customer Support

Thank you for purchasing PLANET products. You can browse our online FAQ resource and User's Manual on PLANET Web site first to check if it could solve your issue. If you need more support information, please contact PLANET switch support team.

PLANET online FAQs:

<https://www.planet.com.tw/en/support/faq>

Switch support team mail address:

support@planet.com.tw

Copyright © PLANET Technology Corp. 2023.

Contents are subject to revision without prior notice.

PLANET is a registered trademark of PLANET Technology Corp.

All other trademarks belong to their respective owners.